



**Bulkington Lane, Nuneaton, CV11 4SB**

**SHELDON  
BOSLEY  
KNIGHT**

LAND AND  
PROPERTY  
PROFESSIONALS



# Property Description

\*\*\* CONSIDERABLY EXTENDED AND SUPERB ORDER \*\*\* Here is a traditional style double semi detached residence situated along this popular main road location within Whitestone offering extended family accommodation in superb order throughout and worthy of an early viewing.

The property offers vastly improved and redesigned accommodation with gas fired central heating, upvc double glazing, driveway for two / three vehicles, long rear garden with extensive wooden decking and combines a wealth of traditional and modern features with feature wooden panelling, picture rails, flag stone flooring, integrated appliances, ornate and feature fireplaces making this a most attractive property.

Briefly comprising: large reaction hall, guests cloakroom, front lounge with bay window, feature fireplace and feature wooden panelled wall, full width dining kitchen with range style cooker, granite working surfaces and integrated appliances, landing, four bedrooms and bathroom with roll top, claw foot bath. Driveway, long rear garden with decking and kids summerhouse. EPC RATING TBC.









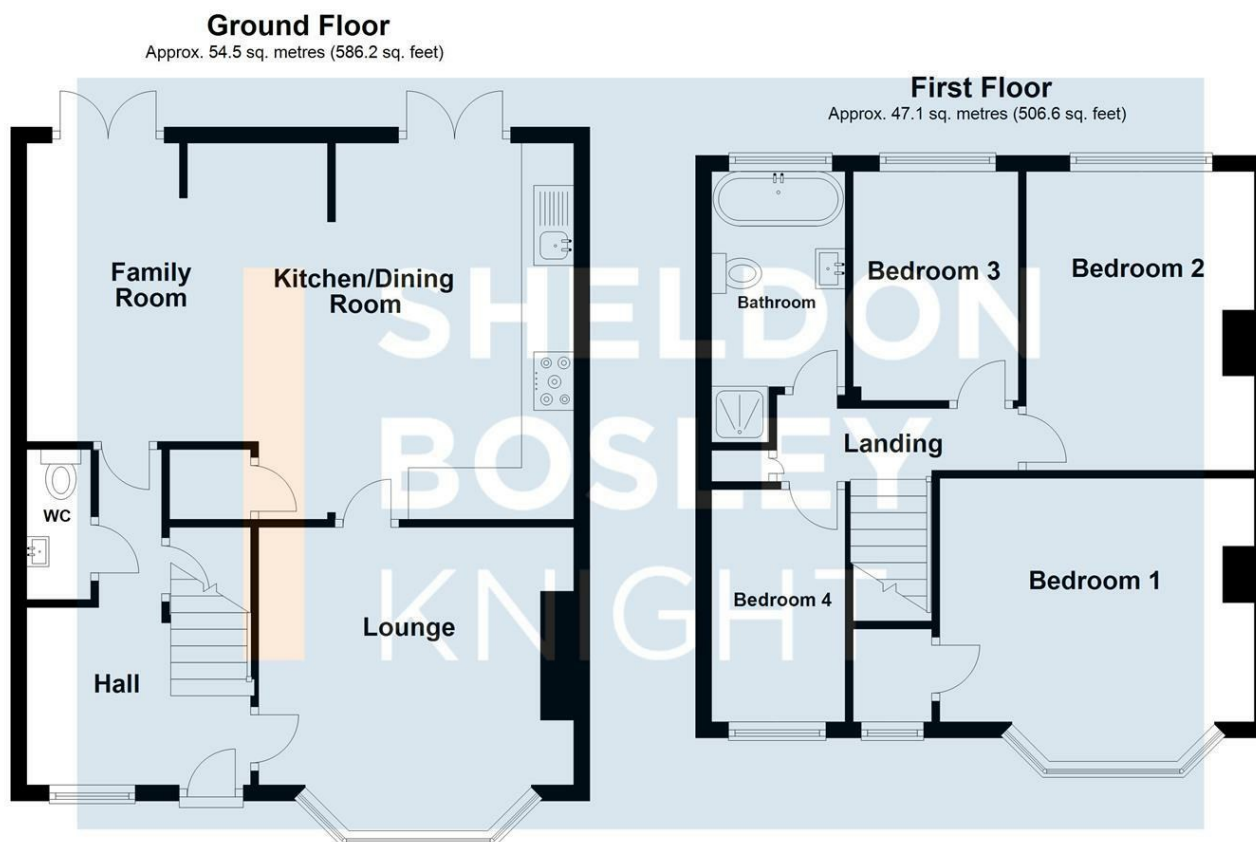

Total area: approx. 101.5 sq. metres (1092.8 sq. feet)

All efforts have been made to ensure that the measurements on this floorplan are accurate however these are for guidance purposes only.  
Plan produced using PlanUp.

## Key Features

- Traditional style semi detached residence
- Considerably extended family home
- Superb order throughout
- Full width dining kitchen
- Lounge with feature fireplace
- Four bedrooms & bathroom
- Drive & long rear garden with decking
- EPC RATING TBC

**£365,000**

EPC Rating - D

Tenure - Freehold

Council Tax Band - C

Local Authority -  
NBBC

We routinely refer clients to both our recommended Legal Firm and a panel of Financial Services Providers. It is your decision whether you choose to deal with these companies. In making that decision, you should know that we receive a referral fee